



## SOCKET WELDING & SCREWED TYPE PIPE FITTINGS



Sekwang pipe fittings are usually made with carbonsteel forgings or bar stocks. They are produced to all internationally recognized standards.

Working Pressure & Screw Type 2000 PSI  
Welding Type SCH80 3000 PSI  
SCH 160 6000 PSI

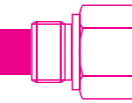

<b>FC</b>	<b>WA</b>	<b>LA</b>	<b>LF</b>	<b>TA</b>
P.122	P.122	P.123	P.123	P.124
<b>TF</b>	<b>CA</b>	<b>WB</b>	<b>LB</b>	<b>TB</b>
P.124	P.125	P.126	P.127	P.128
<b>CB</b>	<b>SPS</b>	<b>WS</b>	<b>LS</b>	<b>TS</b>
P.129	P.130	P.130	P.131	P.131
<b>FA</b>	<b>FAB</b>	<b>FAD</b>	<b>FAE</b>	<b>APA</b>
P.132	P.132	P.133	P.134	P.135
<b>HB</b>	<b>HSA</b>	<b>RSA</b>	<b>SEL</b>	
P.136	P.137	P.137	P.138	

### DESIGNATION PART NUMBER SYSTEM

The symbols in the part number column on each page represent the shape and size of individual fittings.

#### Part Number Examples

**Example 1**

**HB 12R - 04R R**

Name of Fitting (Hex Bushing) | Part (1) Thread Designations(3/4") | Thread Symbol(PT) | Part (2) Thread Designations(1/4")

**Example 2**

**TA - 08 N**

Name of Fitting (Union tee) | Thread Symbol (NPT) | Part (1),(2),(3) Thread Designations(1/2")

Pipe Thread Designations									
Nom. Size	1/8	1/4	3/8	1/2	3/4	1	1 1/4	1 1/2	2
Designation	02R	04R	06R	08R	12R	16R	20R	24R	32R

Thread Symbols	
<b>R</b>	Taper Pipe Threads(PT : JIS B0203, ISO 7/1)
<b>G</b>	American National Standard Taper Pipe Threads(NPT : ANSI B2.1)
<b>N</b>	Parallel Pipe Threads(PF : JIS B0202, ISO 228/1)

#### Material Indication System

Specify material by part number suffix letter : empty = Steel, -SS = Stainless Steel, -B = Brass

**Example 1**

**LA - 04R X**

Carbon Steel

**Example 2**

**TA - 06 N-SS**

Stainless Steel

**Example 3**

**FAD 04 - 02 G - B**

Brass

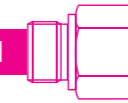

FULL COUPLING

**FC**

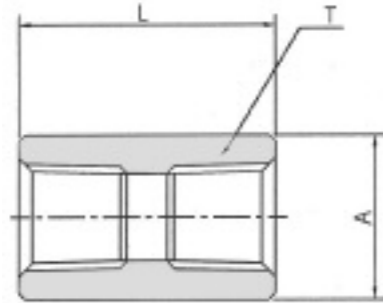

Part No.	T (BSPT)	A	L
FC-02R	1/8	16	31
FC-04R	1/4	20	25
FC-06R	3/8	24	38
FC-08R	1/2	30	48
FC-12R	3/4	36	51
FC-16R	1	46	60
FC-20R	1 1/4	60	66
FC-24R	1 1/2	65	79
FC-32R	2	80	86

90°ELBOW

**LA**

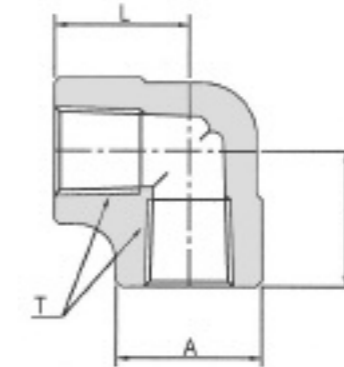

Part No.	T (BSPT)	A	L
LA-02R	1/8	23	22.5
LA-04R	1/4	23	22.5
LA-06R	3/8	27	25
LA-08R	1/2	33	29
LA-12R	3/4	39	34
LA-16R	1	47	38
LA-20R	1 1/4	57	45
LA-24R	1 1/2	63	51
LA-32R	2	76	60

45°ELBOW

**WA**

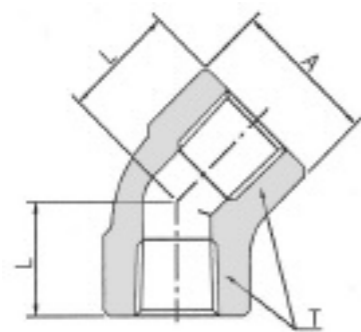

Part No.	T (BSPT)	A	L
WA-02R	1/8	23	20
WA-04R	1/4	23	20
WA-06R	3/8	27	21
WA-08R	1/2	33	24
WA-12R	3/4	39	27.5
WA-16R	1	47	30
WA-20R	1 1/4	57	36
WA-24R	1 1/2	63	40
WA-32R	2	76	47

BSP FIXED FEMALE

**LF**

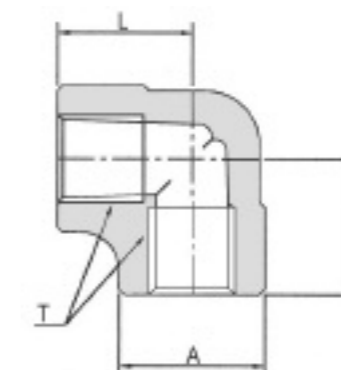

Part No.	Thrads	Dimensions mm		
	T (BSPP)	L1	L2	H
LF-04G	1/4	22.5	22.5	23
LF-06G	3/8	26	26	27
LF-08G	1/2	31	31	33
LF-12G	3/4	34.5	34.5	39
LF-16G	1	41	41	47
LF-20G	1 1/4	43	43	57
LF-24G	1 1/2	53	53	63

SOCKET

SOCKET

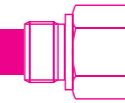

TEE  
**TA**

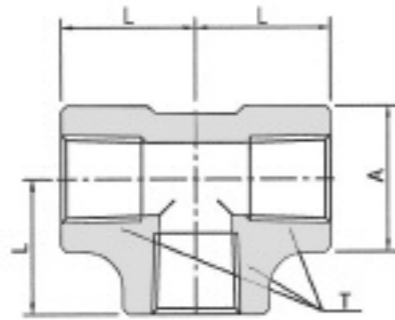

Part No.	T (BSPT)	A	L
TA-02R	1/8	18	22.5
TA-04R	1/4	23	22.5
TA-06R	3/8	27	25
TA-08R	1/2	33	29
TA-12R	3/4	39	34
TA-16R	1	47	38
TA-20R	1 1/4	57	45
TA-24R	1 1/2	63	51
TA-32R	2	76	60

CROSS  
**CA**

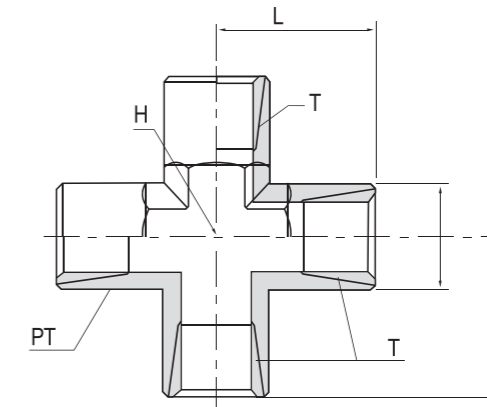

FIXED FEMALE TEE  
**TF**

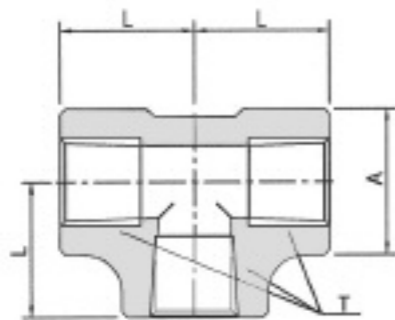

Part No.	Threads	Dimensions mm		
	T (BSPP)	L <sub>1</sub>	L <sub>2</sub>	H
TF-04G	1/4	22.5	22.5	23
TF-06G	3/8	26	26	27
TF-08G	1/2	31	31	33
TF-12G	3/4	34.5	34.5	39
TF-16G	1	41	41	47
TF-20G	1 1/4	43	43	57
TF-24G	1 1/2	53	53	63

Part No.	T (BSPT)	L (Ø)	H
CA-02R	1/8	23	19
CA-04R	1/4	21	22
CA-06R	3/8	25	27
CA-08R	1/2	31	27
CA-12R	3/4	39	34
CA-16R	1	47	38
CA-20R	1 1/4	57	45
CA-24R	1 1/2	63	51
CA-32R	2	76	60

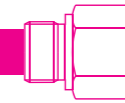

45° ELBOW  
**WB**

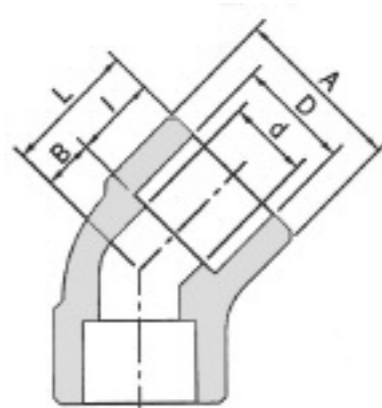

90° ELBOW  
**LB**

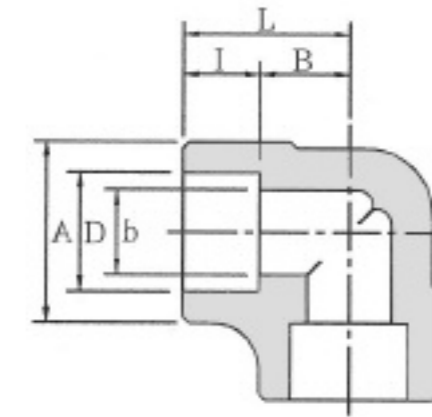

Part No.	Nom Size	D	I	d	A	B	L
<b>Sch.80</b>							
WB04-S80	1/4	14.3	12.1	9.4	23	7.9	20
WB06-S80	3/8	17.8	13.1	12.7	27	7.9	21
WB08-S80	1/2	22.2	12.9	16.1	33	11.1	24
WB12-S80	3/4	27.7	14.8	21.4	39	12.7	27.5
WB16-S80	1	34.5	15.7	27.2	47	14.3	30
WB20-S80	1 1/4	43.2	18.5	35.5	57	17.5	36
WB24-S80	1 1/2	49.1	19.4	41.2	63	20.6	40
WB32-S80	2	61.1	21.6	52.7	76	25.4	47
<b>Sch.160</b>							
WB08-S160	1/2	22.2	14.8	12.3	39	12.7	27.5
WB12-S160	3/4	27.7	15.7	16.2	47	14.3	30
WB16-S160	1	34.5	18.5	21.2	57	17.5	36
WB20-S160	1 1/4	43.2	19.4	29.9	63	20.6	40
WB24-S160	1 1/2	49.1	21.6	34.4	76	25.4	47
WB32-S160	2	61.1	23.0	43.1	96	28.6	51.6

Part No.	Nom Size	D	I	d	A	B	L
<b>Sch.80</b>							
LB04-S80	1/4	14.3	11.4	9.4	23	11.1	22.5
LB06-S80	3/8	17.8	11.5	12.7	27	13.5	25
LB08-S80	1/2	22.2	13.1	16.1	33	15.9	29
LB12-S80	3/4	27.7	14.9	21.4	39	19.1	34
LB16-S80	1	34.5	15.8	27.2	47	22.2	38
LB20-S80	1 1/4	43.2	18.0	35.5	57	27.0	45
LB24-S80	1 1/2	49.1	19.2	41.2	63	31.8	51
LB32-S80	2	61.1	21.9	52.7	76	38.1	60
<b>Sch.160</b>							
LB08-S160	1/2	22.2	14.9	12.3	39	19.1	34
LB12-S160	3/4	27.7	15.8	16.2	47	22.2	38
LB16-S160	1	34.5	18.0	21.2	57	27.0	45
LB20-S160	1 1/4	43.2	19.2	29.9	63	31.8	51
LB24-S160	1 1/2	49.1	21.9	34.4	76	38.1	60
LB32-S160	2	61.1	25.7	43.1	96	41.3	67

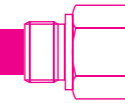

TEE  
**TB**

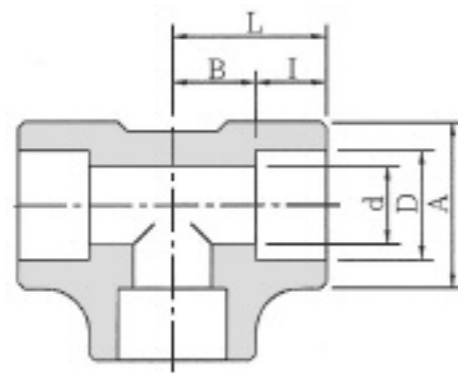

CROSS  
**CB**

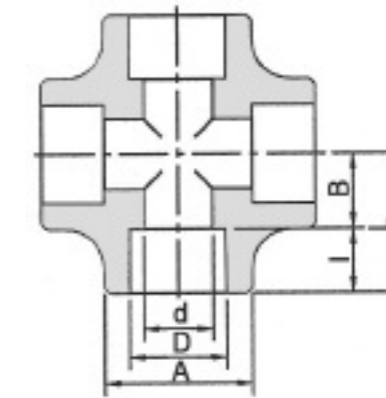

Part No.	Nom Size	D	I	d	A	B	L
<b>Sch.80</b>							
TB04-S80	1/4	14.3	11.4	9.4	23	11.1	22.5
TB06-S80	3/8	17.8	11.5	12.7	27	13.5	25
TB08-S80	1/2	22.2	13.1	16.1	33	15.9	29
TB12-S80	3/4	27.7	14.9	21.4	39	19.1	34
TB16-S80	1	34.5	15.8	27.2	47	22.2	38
TB20-S80	1 1/4	43.2	18.0	35.5	57	27.0	45
TB24-S80	1 1/2	49.1	19.2	41.2	63	31.8	51
TB32-S80	2	61.1	21.9	52.7	76	38.1	60
<b>Sch.160</b>							
TB08-S160	1/2	22.2	14.9	12.3	39	19.1	34
TB12-S160	3/4	27.7	15.8	16.2	47	22.2	38
TB16-S160	1	34.5	18.0	21.2	57	27.0	45
TB20-S160	1 1/4	43.2	19.2	29.9	63	31.8	51
TB24-S160	1 1/2	49.1	21.9	34.4	76	38.1	60
TB32-S160	2	61.1	25.7	43.1	96	41.3	67

Part No.	Nom Size	D	I	d	A	B	L
<b>Sch.80</b>							
CB04-S80	1/4	14.3	11.4	9.4	23	11.1	22.5
CB06-S80	3/8	17.8	11.5	12.7	27	13.5	25
CB08-S80	1/2	22.2	13.1	16.1	33	15.9	29
CB12-S80	3/4	27.7	14.9	21.4	39	19.1	34
CB16-S80	1	34.5	15.8	27.2	47	22.2	38
CB20-S80	1 1/4	43.2	18.0	35.5	57	27.0	45
CB24-S80	1 1/2	49.1	19.2	41.2	63	31.8	51
CB32-S80	2	61.1	21.9	52.7	76	38.1	60
<b>Sch.160</b>							
CB08-S160	1/2	22.2	14.9	12.3	39	19.1	34
CB12-S160	3/4	27.7	15.8	16.2	47	22.2	38
CB16-S160	1	34.5	18.0	21.2	57	27.0	45
CB20-S160	1 1/4	43.2	19.2	29.9	63	31.8	51
CB24-S160	1 1/2	49.1	21.9	34.4	76	38.1	60
CB32-S160	2	61.1	25.7	43.1	96	41.3	67

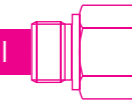

SPECIAL SOCKET  
**SPS**

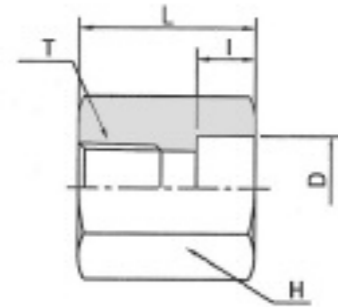

Part No.	T (BSPT)	D	I	L	H
SPS-04R	1/4	14.3	10	30	19
SPS-06R	3/8	17.8	10	30	22
SPS-08R	1/2	22.2	10	40	27
SPS-12R	3/4	27.7	13	43	35
SPS-16R	1	34.5	13	50	41
SPS-20R	1 1/4	43.2	13	55	50
SPS-24R	1 1/2	49.1	13	55	55
SPS-32R	2	61.1	16	64	70

SPECIAL ELBOW  
**LS**

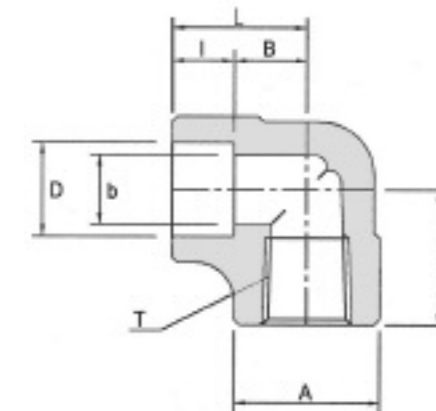

Part No.	T (BSPT)	D	I	d	A	B	L
LS-04R	1/4	14.3	11.4	9.4	23	11.1	22.5
LS-06R	3/8	17.8	11.5	12.7	27	13.5	25
LS-08R	1/2	22.2	13.1	16.1	33	15.9	29
LS-12R	3/4	27.7	14.9	21.4	39	19.1	34
LS-16R	1	34.5	15.8	27.2	47	22.2	38
LS-20R	1 1/4	43.2	18.0	35.5	57	27.0	45
LS-24R	1 1/2	49.1	19.2	41.2	63	31.8	51
LS-32R	2	61.1	21.9	52.7	76	38.1	60

45° SPECIAL ELBOW  
**WS**

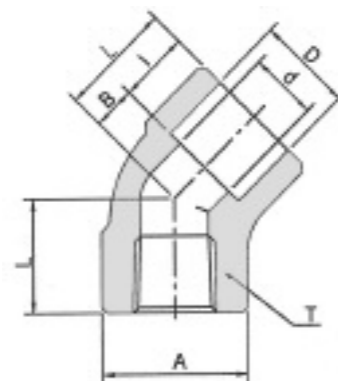

Part No.	T (BSPT)	D	I	d	A	B	L
WS-04R	1/4	14.3	12.1	9.4	23	7.9	20
WS-06R	3/8	17.8	13.1	12.7	27	7.9	21
WS-08R	1/2	22.2	12.9	16.1	33	11.1	24
WS-12R	3/4	27.7	14.8	21.4	39	12.7	27.5
WS-16R	1	34.5	15.9	27.2	47	14.3	30
WS-20R	1 1/4	43.2	18.5	35.5	57	17.5	36
WS-24R	1 1/2	49.1	19.4	41.2	63	20.6	40
WS-32R	2	61.1	21.6	52.7	76	25.4	47

SPECIAL TEE  
**TS**

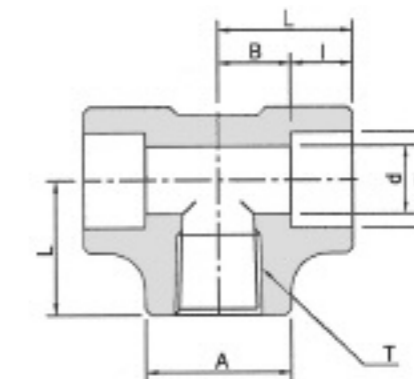

Part No.	T (BSPT)	D	I	d	A	B	L
TS-04R	1/4	14.3	11.4	9.4	23	11.1	22.5
TS-06R	3/8	17.8	11.5	12.7	27	13.5	25
TS-08R	1/2	22.2	13.1	16.1	33	15.9	29
TS-12R	3/4	27.7	14.9	21.4	39	19.1	34
TS-16R	1	34.5	15.8	27.2	47	22.2	38
TS-20R	1 1/4	43.2	18.0	35.5	57	27.0	45
TS-24R	1 1/2	49.1	19.2	41.2	63	31.8	51
TS-32R	2	61.1	21.9	52.7	76	38.1	60

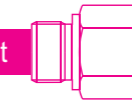

FEMALE ADAPTER 'A' TYPE

**FA**

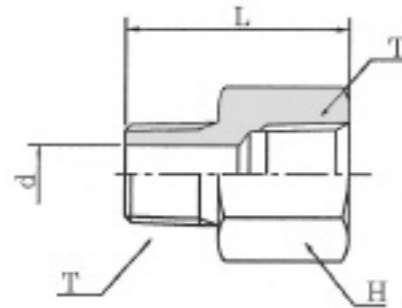

Part No.	T (BSPT)	d	L	H
FA-04R	1/4	7	31	19
FA-06R	3/8	9	37	22
FA-08R	1/2	12	44.5	27
FA-12R	3/4	16	50	35
FA-16R	1	20	58	41
FA-20R	1 1/4	28	67	50
FA-24R	1 1/2	32	69	55
FA-32R	2	40	79	70

FEMALE ADAPTER 'D' TYPE

**FAD**

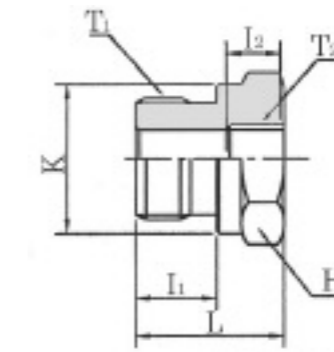

FEMALE ADAPTER 'B' TYPE

**FAB**

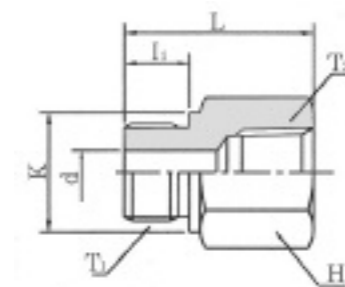

Part No.	T <sub>1</sub> (BSPP)	T <sub>2</sub> (BSPT)	d	k	l <sub>1</sub>	L	H
FAB-04G	1/4	1/4	6	19	12	33	19
FAB-06G	3/8	3/8	8	22	12	35	22
FAB-08G	1/2	1/2	12	27	14	42	27
FAB-12G	3/4	3/4	16	35	16	47	35
FAB-16G	1	1	22	41	18	55	41
FAB-20G	1 1/4	1 1/4	28	50	20	63	50
FAB-24G	1 1/2	1 1/2	31	55	21	66	55
FAB-32G	2	2	36	75	25	76	75

Part No.	T <sub>1</sub> (BSPP)	T <sub>2</sub> (BSPP)	K	l <sub>1</sub>	l <sub>2</sub>	L	H
FAD06G-02G	3/8	1/8	22	12	8	22	22
FAD08G-04G	1/2	1/4	26	14	12	24	27
FAD12G-04G	3/4	1/4	32	16	12	26	32
FAD12G-06G	3/4	3/8	32	16	12	26	32
FAD16G-04G	1	1/4	39	18	12	29	41
FAD16G-06G	1	3/8	39	18	12	29	41
FAD16G-08G	1	1/2	39	18	14	29	41
FAD20G-08G	1 1/4	1/2	49	20	14	32	50
FAD20G-12G	1 1/4	3/4	49	20	16	32	50
FAD24G-08G	1 1/2	1/2	55	22	14	36	55
FAD24G-12G	1 1/2	3/4	55	22	16	36	55
FAD24G-16G	1 1/2	1	55	22	18	36	55



FEMALE ADAPTER 'E' TYPE  
**FAE**

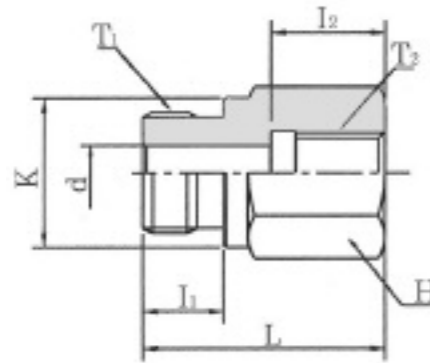

Part No.	T <sub>1</sub> (BSPP)	T <sub>2</sub> (BSPP)	K	d	l <sub>1</sub>	l <sub>2</sub>	L	H
FAE02G-04G	1/8	1/4	14	4	8	17	31	19
FAE02G-06G	1/8	3/8	14	4	8	17	32	24
FAE04G-02G	1/4	1/8	18	5	12	12	28	19
FAE04G-06G	1/4	3/8	18	5	12	17	36	24
FAE04G-08G	1/4	1/2	18	5	12	20	40	30
FAE04G-12G	1/4	3/4	18	5	12	22	43	36
FAE06G-04G	3/8	1/4	22	8	12	17	36	22
FAE06G-08G	3/8	1/2	22	8	12	20	41	30
FAE06G-12G	3/8	3/4	22	8	12	22	44	36
FAE08G-06G	1/2	3/8	26	12	14	17	36	27
FAE08G-12G	1/2	3/4	26	12	14	22	46	36
FAE08G-16G	1/2	1	26	12	14	24.5	49	41
FAE08G-20G	1/2	1 1/4	26	10	14	26.5	53	55
FAE12G-08G	3/4	1/2	32	16	16	20	41	32
FAE12G-16G	3/4	1	32	16	16	24.5	51	41
FAE12G-20G	3/4	1 1/4	32	16	16	26.5	56	55
FAE12G-24G	3/4	1 1/2	32	16	16	28.5	57	60
FAE16G-12G	1	3/4	39	20	18	22	47	41
FAE16G-20G	1	1 1/4	39	20	18	26.5	57	55
FAE16G-24G	1	1 1/2	39	20	18	28.5	59	60
FAE20G-16G	1 1/4	1	49	25	20	24.5	52	50
FAE20G-24G	1 1/4	1 1/2	49	25	20	28.5	60	60
FAE24G-20G	1 1/2	1 1/4	55	25	22	26.5	58	55

REDUCER 'A' TYPE  
**APA**

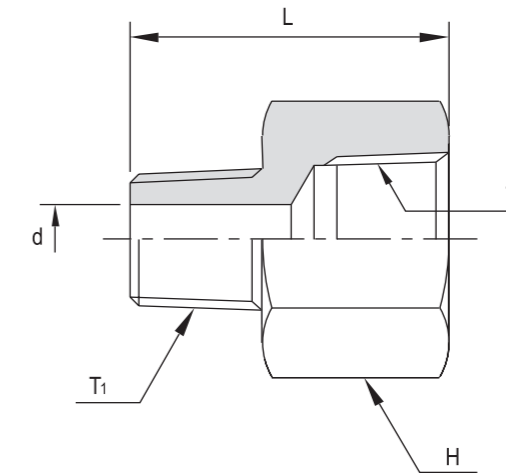

Part No.	T <sub>1</sub> (BSPT)	T <sub>2</sub> (BSPT)	d	L	H
APA02R-04R	1/8	1/4	4	29	19
APA02R-06R	1/8	3/8	4	35	22
APA04R-06R	1/4	3/8	7	35	22
APA04R-08R	1/4	1/2	7	39	27
APA04R-12R	1/4	3/4	7	44	35
APA06R-08R	3/8	1/2	9	44	27
APA06R-12R	3/8	3/4	9	44	35
APA06R-16R	3/8	1	9	47	41
APA08R-12R	1/2	3/4	12	44	35
APA08R-16R	1/2	1	12	52	41
APA08R-20R	1/2	1 1/4	12	56	50
APA12R-16R	3/4	1	16	53	41
APA12R-20R	3/4	1 1/4	16	59	50
APA12R-24R	3/4	1 1/2	16	60	55
APA16R-20R	1	1 1/4	20	64	50
APA16R-24R	1	1 1/2	20	64	55
APA16R-32R	1	2	20	69	70
APA20R-24R	1 1/4	1 1/2	28	69	55
APA20R-32R	1 1/4	2	28	73	70
APA24R-32R	1 1/2	2	32	75	70

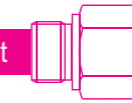

## HEX BUSHING HB

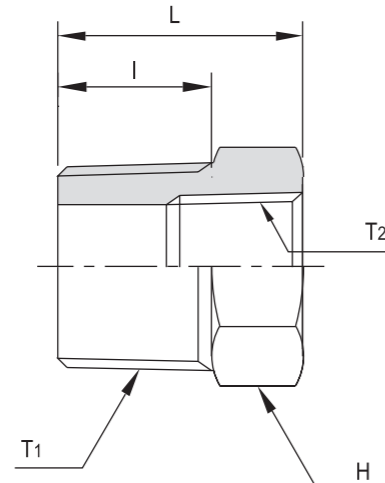

Part No.	T <sub>1</sub> (BSPT)	T <sub>2</sub> (BSPT)	I	L	H
HB04R-02R	1/4	1/8	14	21	14
HB06R-04R	3/8	1/4	16	24	19
HB08R-04R	1/2	1/4	19	29	22
HB08R-06R	1/2	3/8	19	29	22
HB12R-02R	3/4	1/8	20	30	27
HB12R-04R	3/4	1/4	20	31.5	27
HB12R-06R	3/4	3/8	20	31.5	27
HB12R-08R	3/4	1/2	20	31.5	27
HB16R-04R	1	1/4	23	35	35
HB16R-06R	1	3/8	23	35	35
HB16R-08R	1	1/2	23	35	35
HB16R-12R	1	3/4	23	35	35
HB20R-08R	1 1/4	1/2	25.4	41.5	43
HB20R-12R	1 1/4	3/4	25.4	41.5	43
HB20R-16R	1 1/4	1	25.4	41.5	44
HB24R-08R	1 1/2	1/2	25.4	41.5	50
HB24R-12R	1 1/2	3/4	25.4	41.5	50
HB24R-16R	1 1/2	1	25.4	41.5	50
HB24R-20R	1 1/2	1 1/4	25.4	41.5	50
HB32R-12R	2	3/4	31	51	65
HB32R-16R	2	1	31	51	63.5
HB32R-20R	2	1 1/4	31	51	65
HB32R-24R	2	1 1/2	31	51	65

## HEX SOCKET HSA

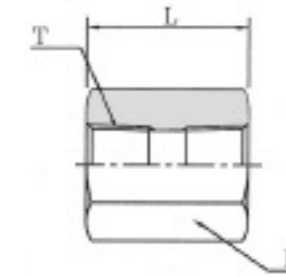

Part No.	T (BSPT)	H	L
HSA-02R	1/8	14	25
HSA-04R	1/4	19	27
HSA-06R	3/8	24	30
HSA-08R	1/2	27	42
HSA-12R	3/4	35	42
HSA-16R	1	41	50
HSA-20R	1 1/4	50	55
HSA-24R	1 1/2	55	55
HSA-32R	2	70	64

## REDUCING SOCKET RSA

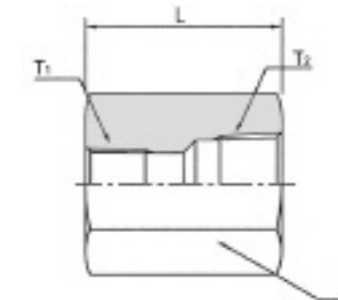

Part No.	T <sub>1</sub> (BSPT)	T <sub>2</sub> (BSPT)	L	H
RSA04R-02R	1/4	1/8	30	19
RSA06R-04R	3/8	1/4	30	22
RSA08R-04R	1/2	1/4	40	27
RSA08R-06R	1/2	3/8	40	27
RSA12R-04R	3/4	1/4	42	35
RSA12R-06R	3/4	3/8	42	35
RSA12R-08R	3/4	1/2	42	35
RSA16R-06R	1	3/8	50	41
RSA16R-08R	1	1/2	50	41
RSA16R-12R	1	3/4	50	41
RSA20R-08R	1 1/4	1/2	55	50
RSA20R-12R	1 1/4	3/4	55	50
RSA20R-16R	1 1/4	1	55	50
RSA24R-12R	1 1/2	3/4	55	55
RSA24R-16R	1 1/2	1	55	55
RSA24R-20R	1 1/2	1 1/4	55	55
RSA32R-16R	2	1	64	70
RSA32R-20R	2	1 1/4	64	70
RSA32R-24R	2	1 1/2	64	70

90° SERVICE ELBOW

**SEL**

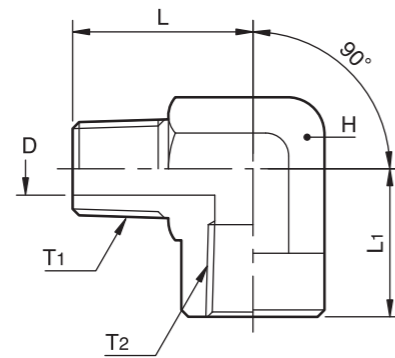

Part No.	T <sub>1</sub> (BSPT)	T <sub>2</sub> (BSPT)	D	H	L	L <sub>1</sub>
SEL 02R-02R	1/8	1/8	4.5	14	21	19
SEL 04R-04R	1/4	1/4	5.5	19	27	22
SEL 06R-06R	3/8	3/8	9	24	33	27
SEL 08R-08R	1/2	1/2	11.5	27	38	30
SEL 12R-12R	3/4	3/4	15.5	35	44	34
SEL 16R-16R	1	1	20	41	48	40
SEL 20R-20R	1 1/4	1 1/4	26	50	65	45
SEL 24R-24R	1 1/2	1 1/2	33	65	66	59
SEL 32R-32R	2	2	43	70	72	60